

Mounting plates

for hinges with safety switch GN 139.1 / GN 139.2, flat

SPECIFICATION

Steel
Zinc plated and plastic coated
silver metallic

INFORMATION

The flat mounting plate GN 139.3 allows the hinges GN 139.1 (see page 1440) / GN 139.2 (see page 1443) to be attached from the front.

The long slotted holes also allow the attachment to profile systems. Countersunk screws for fixing the hinges to the mounting plate are an included part of the order.

Mounting plates

for hinges with safety switch GN 139.1 / GN 139.2, angled

SPECIFICATION

Zinc die casting
plastic coated
silver metallic

INFORMATION

The angled mounting plate GN 139.4 allows the hinges GN 139.1 (see page 1440) / GN 139.2 (see page 1443) to be attached between frame and door, i.e. the door gap.

The long slotted holes also allow the attachment to profile systems. Countersunk screws for fixing the hinges to the mounting plate are an included part of the order.

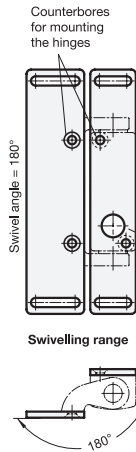
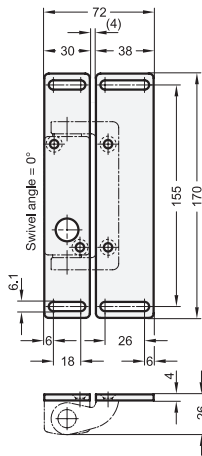

Application example

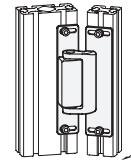

Bore for type C / CK (connection type)

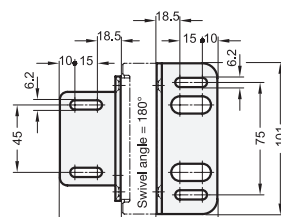
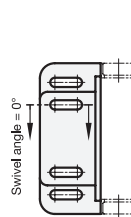

Application example

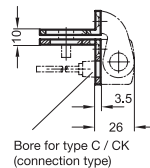
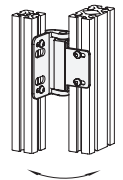

GN 139.3

Description	I	⚖
GN 139.3-170	170	358

GN 139.4

Description	I	⚖
GN 139.4-101	101	241